



# VENTOSOL

MOTORIZED INTERIOR OR EXTERIOR TENSIONED ZIPPER SYSTEMS



STOBAG





Zipper System

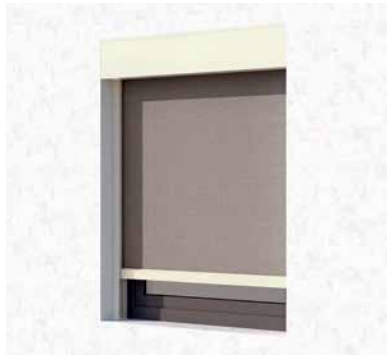

Soffit Mounting



Square Box

- Modern cubic box shape
- Design with clear lines, no disruptive plastic parts
- Drop profile recessed into the box
- Motor drive with obstacle detection available
- New connection between box and guide rails simplifies assembly
- Service-friendly version (service opening + simple removal of the fabric shaft)
- Blockout variant optional
- New 2-piece guide rail with zipper system for high fabric tension

min. 3'-0"  
max. 14'-0"

min. 3'-0"  
max. 13'-0"

CLASS 3  
BEAUFORT 6

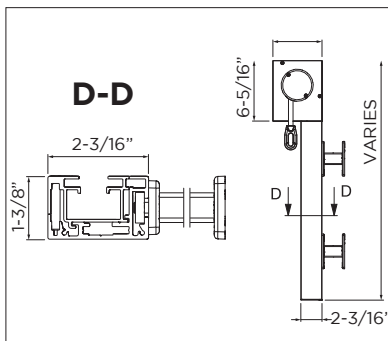

Mounting w/ Fastening Brackets

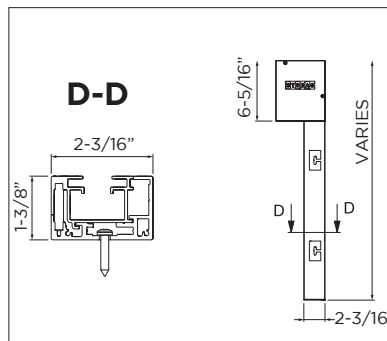

Soffit Mounting

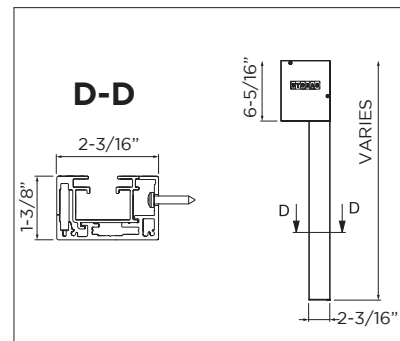

Wall Mounting w/ Direct Screw Connection

COLORS\*  
White

FABRICS  
Choose from a comprehensive range of materials and colors.

ELECTRONICS **somfy**  
More convenience thanks to the automated control and lighting systems.

\*Optional custom colors available.



**abc Sun Control Systems**  
7241 Ethel Avenue, North Hollywood, CA 91605  
Phone: 818-982-6989 Fax: 818-982-9171  
abcsuncontrolsystems.com

**"Finely Crafted Shade Systems"**

